



**WINKEL-Rollen | WINKEL Bearings**

**Standard NbV-Profile**

- Alle Profile sind ab Standard 0 NbV aus hochwertigem warmgewalzten Stahl in S450 J2 mod. gefertigt und sandgestrahlt.  $L_{max} = 12\text{ m}$
- Passend zu unserem WINKEL-Rollensystem liefern wir alle Profiltypen in Fixlängen sofort ab Lager.
- Auf Wunsch sind alle Profile in feingerichteter Ausführung erhältlich ( $\pm 0,3\text{ mm/lfm.}$ )
- Höhere Tragkräfte durch neue NbV-Serie
- *Komplette Profilbearbeitung nach Kundenzeichnungen auf Anfrage*

CAD Download in 2D/3D unter [www.winkel.de](http://www.winkel.de)



**Standard NbV-profiles**

- All profiles from Standard 0 NbV on are made from high-quality hot rolled steel S450 J2 mod., in sandblasted version.  $L_{max} = 12\text{ m}$
- Suitable for WINKEL Bearing system, we deliver all profiles in fixed lengths, immediately from stock
- All profiles are available in fine straightened style on request ( $\pm 0,3\text{ mm per meter}$ )
- Higher load capacity with new NbV-series
- *Machined profiles according to customer drawings on request*

CAD download in 2D/3D at [www.winkel.de](http://www.winkel.de)



**Standard A**

Artikel-Nr. 113.001.000  
Article no.

m	2,62 kg/m
A	3,3 cm <sup>2</sup>
Ix	10,6 cm <sup>4</sup>
Wx	4,4 cm <sup>3</sup>
Iy	1,7 cm <sup>4</sup>
Wy	1,0 cm <sup>3</sup>
ey	0,8 cm

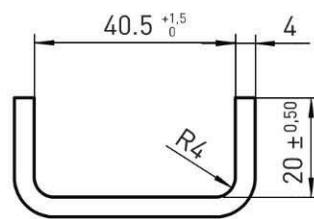

Materialgüte S235 JR  
Material S235 JR

- In kaltgewalzter Ausführung
- In cold rolled version

$L_{max} = 12\text{ m}$

**Standard S**

Artikel-Nr. 113.002.000  
Article no.

m	5,3 kg/m
A	6,4 cm <sup>2</sup>
Ix	35,4 cm <sup>4</sup>
Wx	10,9 cm <sup>3</sup>
Iy	5,0 cm <sup>4</sup>
Wy	2,5 cm <sup>3</sup>
ey	1,0 cm

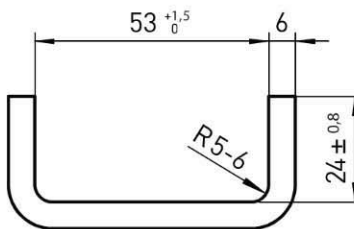

Materialgüte S235 JR  
Material S235 JR

- In kaltgewalzter Ausführung
- In cold rolled version

$L_{max} = 12\text{ m}$

Hinweis: Feingerichtete Profile weisen eine Geradheit von  $\pm 0,3\text{ mm/lfm.}$  auf. Standard  $\pm 1,0\text{ mm/lfm.}$   
Notice: The straightness for fine straightened profiles is  $\pm 0,3\text{ mm per meter}$ . Standard  $\pm 1,0\text{ mm per meter}$



WINKEL-Rollen | WINKEL Bearings

**Standard 0 NbV**

Artikel-Nr. 113.010.000  
Article no.

m	10,5	kg/m
A	13,4	cm <sup>2</sup>
Ix	136,6	cm <sup>4</sup>
Wx	31,6	cm <sup>3</sup>
Iy	15,4	cm <sup>4</sup>
Wy	6,7	cm <sup>3</sup>
ey	1,3	cm

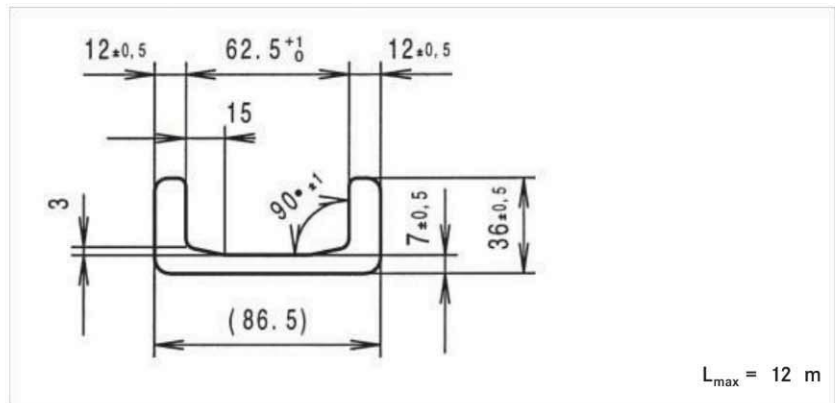

**Standard 1 NbV**

Artikel-Nr. 113.011.000  
Article no.

m	14,8	kg/m
A	18,8	cm <sup>2</sup>
Ix	272,9	cm <sup>4</sup>
Wx	52,9	cm <sup>3</sup>
Iy	27,3	cm <sup>4</sup>
Wy	10,9	cm <sup>3</sup>
ey	1,5	cm

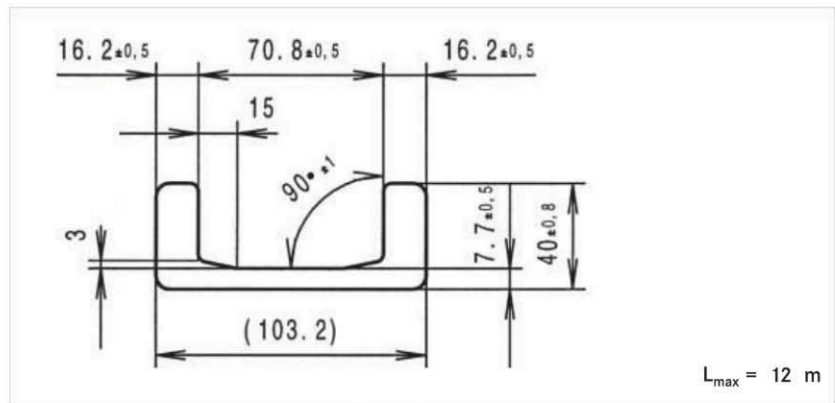

**Standard 2 NbV**

Artikel-Nr. 113.012.000  
Article no.

m	20,9	kg/m
A	26,6	cm <sup>2</sup>
Ix	492,7	cm <sup>4</sup>
Wx	81,2	cm <sup>3</sup>
Iy	37,9	cm <sup>4</sup>
Wy	14,8	cm <sup>3</sup>
ey	1,5	cm

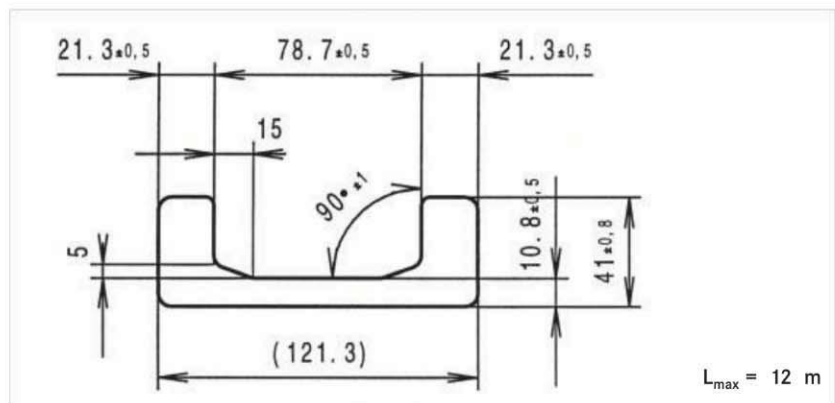

**Standard 3 NbV**

Artikel-Nr. 113.013.000  
Article no.

m	28,6	kg/m
A	36,4	cm <sup>2</sup>
Ix	864,1	cm <sup>4</sup>
Wx	127,6	cm <sup>3</sup>
Iy	89,5	cm <sup>4</sup>
Wy	27,1	cm <sup>3</sup>
ey	2,0	cm

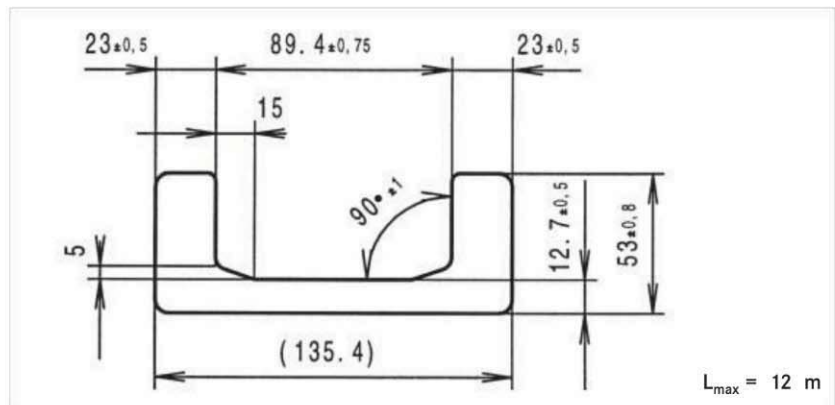



WINKEL-Rollen | WINKEL Bearings

**Standard 4 NbV**

Artikel-Nr. 113.014.000  
Article no.

m	36,0	kg/m
A	45,7	cm <sup>2</sup>
I <sub>x</sub>	1490,4	cm <sup>4</sup>
W <sub>x</sub>	189,6	cm <sup>3</sup>
I <sub>y</sub>	150,3	cm <sup>4</sup>
W <sub>y</sub>	38,8	cm <sup>3</sup>
e <sub>y</sub>	2,2	cm

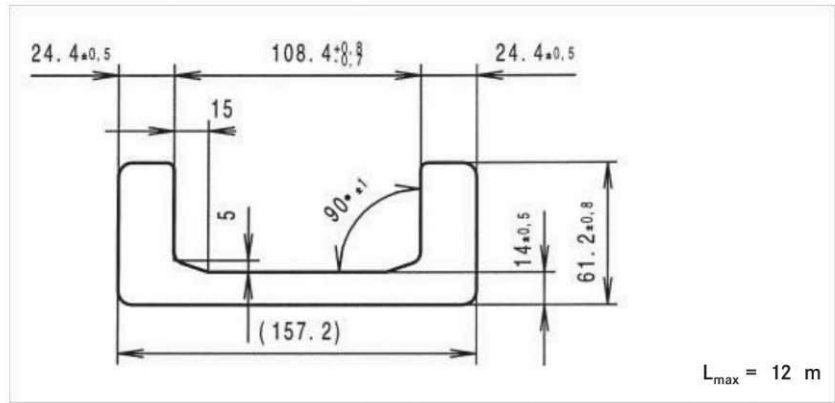

**Standard 5 NbV**

Artikel-Nr. 113.015.000  
Article no.

m	42,8	kg/m
A	54,6	cm <sup>2</sup>
I <sub>x</sub>	2180,4	cm <sup>4</sup>
W <sub>x</sub>	249,2	cm <sup>3</sup>
I <sub>y</sub>	205,0	cm <sup>4</sup>
W <sub>y</sub>	48,2	cm <sup>3</sup>
e <sub>y</sub>	2,4	cm

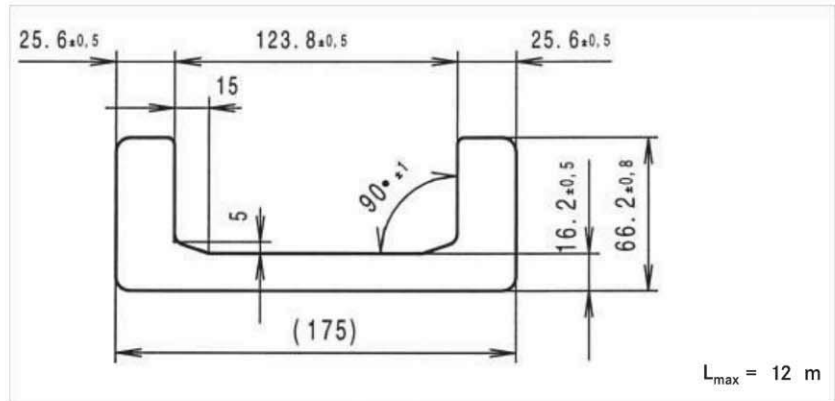

**Standard 6 NbV**

Artikel-Nr. 113.016.000  
Article no.

m	52,3	kg/m
A	66,6	cm <sup>2</sup>
I <sub>x</sub>	3430,2	cm <sup>4</sup>
W <sub>x</sub>	340,5	cm <sup>3</sup>
I <sub>y</sub>	270,0	cm <sup>4</sup>
W <sub>y</sub>	57,2	cm <sup>3</sup>
e <sub>y</sub>	2,4	cm

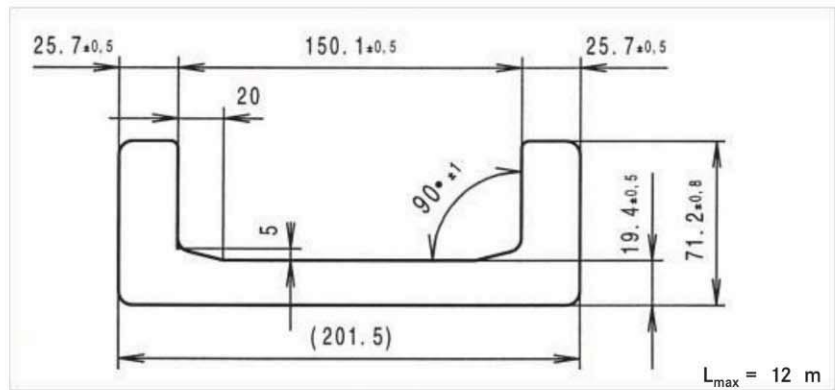

NEU  
NEW

**Standard 8 NbV**

Artikel-Nr. 113.018.000  
Article no.

m	78,75	kg/m
A	100,1	cm <sup>2</sup>
I <sub>x</sub>	8605,4	cm <sup>4</sup>
W <sub>x</sub>	681,6	cm <sup>3</sup>
I <sub>y</sub>	721,5	cm <sup>4</sup>
W <sub>y</sub>	125,1	cm <sup>3</sup>
e <sub>y</sub>	3,2	cm

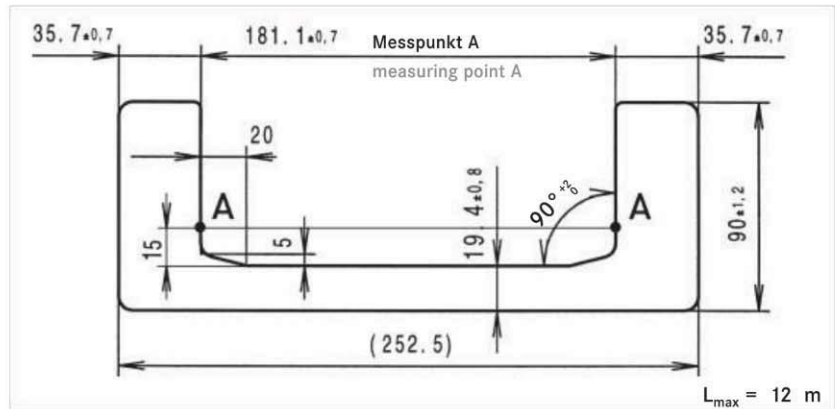

Hinweis: Feingerichtete Profile weisen eine Geradheit von ± 0,3 mm/lfm. auf. Standard ± 1,0 mm/lfm.  
Notice: The straightness for fine straightened profiles is ± 0,3 mm per meter. Standard ± 1,0 per meter